

Lobby Level

	Length & Width	Sq. Ft.	Sq. M.	Ceiling Height	Rept.	Banquet	Theatre	½ Rounds	Class Room	U-Shape	Hollow Square	Board Room
Atrium Lobby	Please ask about this unique & flexible venue											
Crystal Pavilion	92 x 74	6808	613	12	700	600	700	300	400	160	190	85
Pavilion A or B & C	74 x 46	3404	306	12	350	280	340	140	180	75	88	62
Pavilion B or C	46 x 37	1702	153	12	150	150	160	75	90	35	42	36
Gazebo 1 & 2	74 x 25	1850	167	9.5	150	120	120	60	60	50	58	46
Gazebo 1 or 2	37 x 25	925	83	9.5	75	60	70	30	30	27	34	26
Boardroom	20 x 18	360	32	9.5	-	-	-	-	-	-	-	12

Foyer

Crystal Pavilion A	80 x 30	2400	-	-	275	-	-	-	-	-	-	-
Crystal Pavilion B & C	50 x 10	500	-	-	50	-	-	-	-	-	-	-

Notes

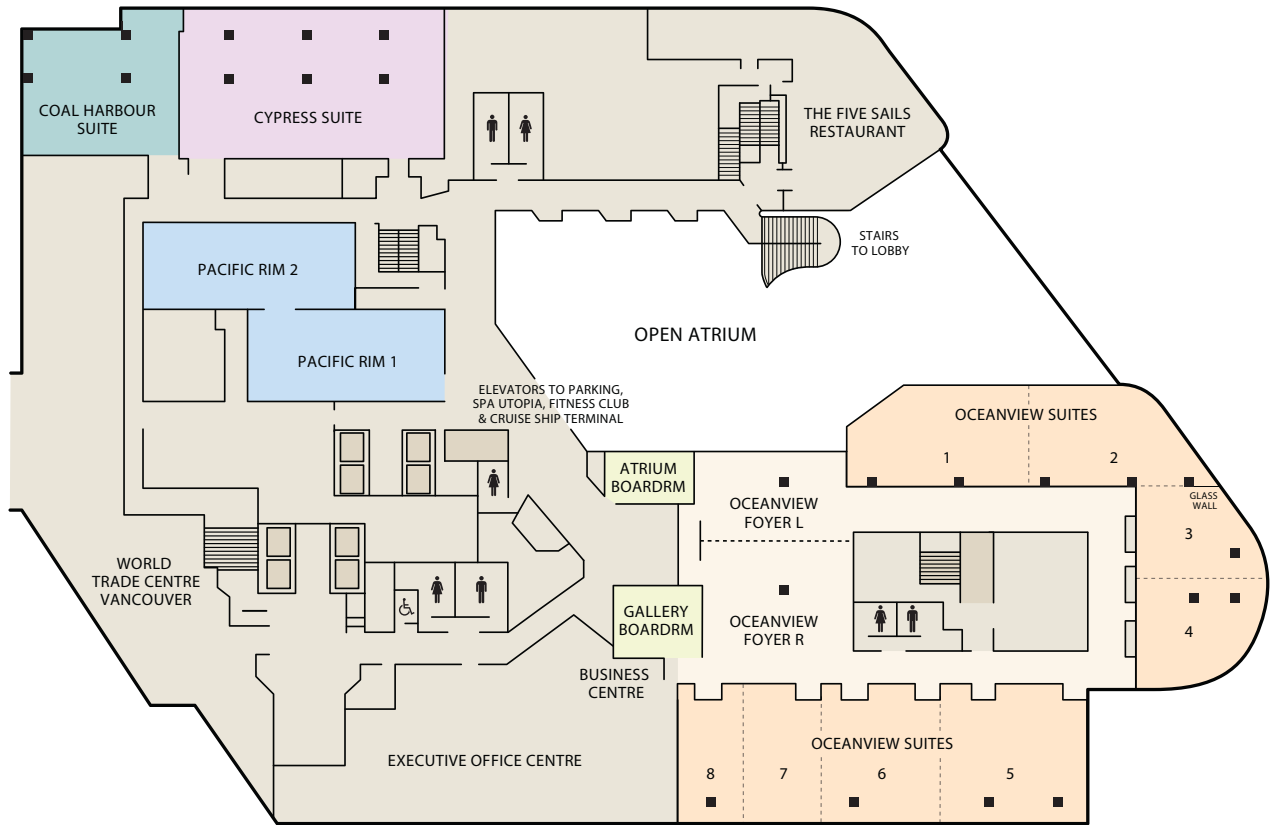

Restaurant and Gallery Level

	Length & Width	Sq. Ft.	Sq. M.	Ceiling Height	Rept.	Banquet	Theatre	½ Rounds	Class Room	U-Shape	Hollow Square	Board Room
Cypress Suite	78 x 47	3666	330	8.5	250	190	100	95	-	24	28	34
Coal Harbour Suite	38 x 51	2096	194	8.5	150	120	120	60	60	40	46	38
Pacific Rim 1	23 x 57	1388	129	8.6	100	100	130	50	42	38	44	36
Pacific Rim 2	25 x 61	1581	146	8.6	120	120	150	60	80	44	52	42
Atrium Boardroom	12 x 22	276	26	8.6	-	-	-	-	-	-	-	8
Gallery Boardroom	19 x 29	551	42	8.6	-	-	-	-	-	-	-	20
Oceanview 1	29 x 51	1433	133	8.6	100	80	105	40	54	39	48	38
Oceanview 2	29 x 58	1455	135	8.6	100	80	105	40	54	39	48	40
Oceanview 3	28 x 39	1105	102	8.6	80	50	50	25	38	29	38	26
Oceanview 4	28 x 38	1065	99	8.6	75	50	50	25	28	24	28	20
Oceanview 1 – 4	-	5058	470	8.6	350	270	-	-	-	-	-	-
Oceanview 5	39 x 38	1482	133	8.6	120	90	120	45	60	32	44	28
Oceanview 6	35 x 38	1330	120	8.6	100	80	100	40	52	30	40	28
Oceanview 7	26 x 38	988	89	8.6	80	60	80	30	45	30	36	28
Oceanview 8	20 x 38	760	68	8.6	40	30	30	-	18	16	22	16
Oceanview 5 – 8	120 x 38	4560	410	8.6	400	340	350	150	-	-	-	-
Oceanview 1 – 8	-	-	-	8.6	750	-	-	-	-	-	-	-

Foyer

Oceanview Foyer Left	40 x 25	1000	-	-	100	-	-	-	-	-	-	-
Oceanview Foyer Right	40 x 34	1360	-	-	250	-	-	-	-	-	-	-
Oceanview Foyer Left & Right	40 x 62	2480	-	-	375	-	-	-	-	-	-	-

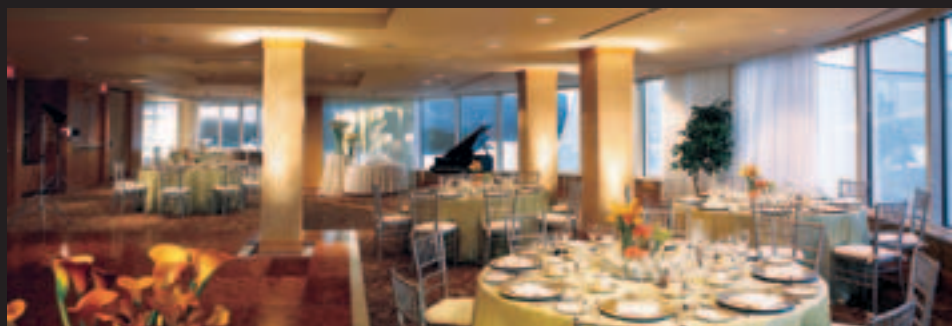

A Landmark of Quality and Distinction

The Pan Pacific Vancouver occupies a privileged position atop the magnificent Canada Place Complex on Vancouver's breathtaking waterfront. Guests enjoy panoramic views of the city, harbour and coastal mountains. Sharing and adjacent to this pristine Canada Place location is the Vancouver Convention Centre (east & west) and the Vancouver Cruise Ship terminal. Venturing off property? The Vancouver business district and vibrant entertainment center are only a stroll away.

Since 1986, the Pan Pacific Vancouver has earned an unparalleled reputation for gracious hospitality and service excellence.

Event Space

The stunning backdrops and West Coast ambiance speaks for itself, enhancing spectacular events, successful meetings, global conferences attended by world leaders and unforgettable celebrations.

Over 42,000 square feet of event space is anchored by the Crystal Pavilion, an elegant ballroom for up to 700, while the Oceanview Suites offer the ultimate in multi-functionality. Eight spacious meeting rooms with floor to ceiling views offer natural light for daytime meetings or transform into an exclusive moonlit reception arena for up to 750 guests.

With in-house Audio Visual service and technical support, our impeccable service extends to state-of-the-art meeting room technology, culinary excellence and a catering team that is sure to impress.

Whether it is the Gallery Boardroom for 20 or our airy Lobby Atrium for 1200 guests, Pan Pacific Vancouver sets the stage for extraordinary event experiences.

Guestrooms and Suites

503 Guestrooms & Suites

- 225 Double Doubles
- 237 Kings
- 10 City Suites
- 11 Bayview Suites (1,2 or 3 bedroom)
- 11 Mountain Parlours (1 or 2 bedroom)
- 2 Balcony Suites (1 or 2 bedroom)
- 5 Luxury Suites (1 or 2 bedroom)
- Pacific Club Floor & Lounge
- Residence Suite (1, 2, 3 or 4 bedroom)
- 13 Guestrooms designed for the comfort and accessibility of special needs travelers

Special Features

- Full Service Business Centre
- Internet Centre
- Airline Boarding Pass Centre
- Spa Utopia and Salon
- Fitness Club
- Outdoor Heated Saltwater Pool (year round)
- Outdoor Whirlpool
- Gift Shops
- Underground Parking
- Valet Parking

Pan Pacific Dining

- Five Sails Restaurant
 - Café Pacifica
 - Cascades Lounge
 - Patio Terrace
- * Our food and beverage venues are also available for private functions*

Guest Services

- Concierge
- Multi-Lingual Associates
- 24 Hour Room Service
- 24 Hour Laundry/Valet
- Air Conditioned
- Movie Channels (150) Guest Choice
- High Speed Internet (wireless)
- Evening Turndown Service
- Starbucks In-Room Coffee
- Complimentary Overnight Shoe-Shine
- Ving Card Security System



PAN PACIFIC
Vancouver

300 – 999 Canada Place, Vancouver, BC V6C 3B5 Tel: 604 662-8111 Fax: 604 685-8690
Toll-free Canada: 1-800-663-1515 Toll-free USA: 1-800-937-1515
E-mail: reservations@panpacific-hotel.com www.panpacificvancouver.com